

Land Stewardship Proposal for the Lake Almanor Planning Unit

~ *Bailey Creek Open Space Corridor* ~

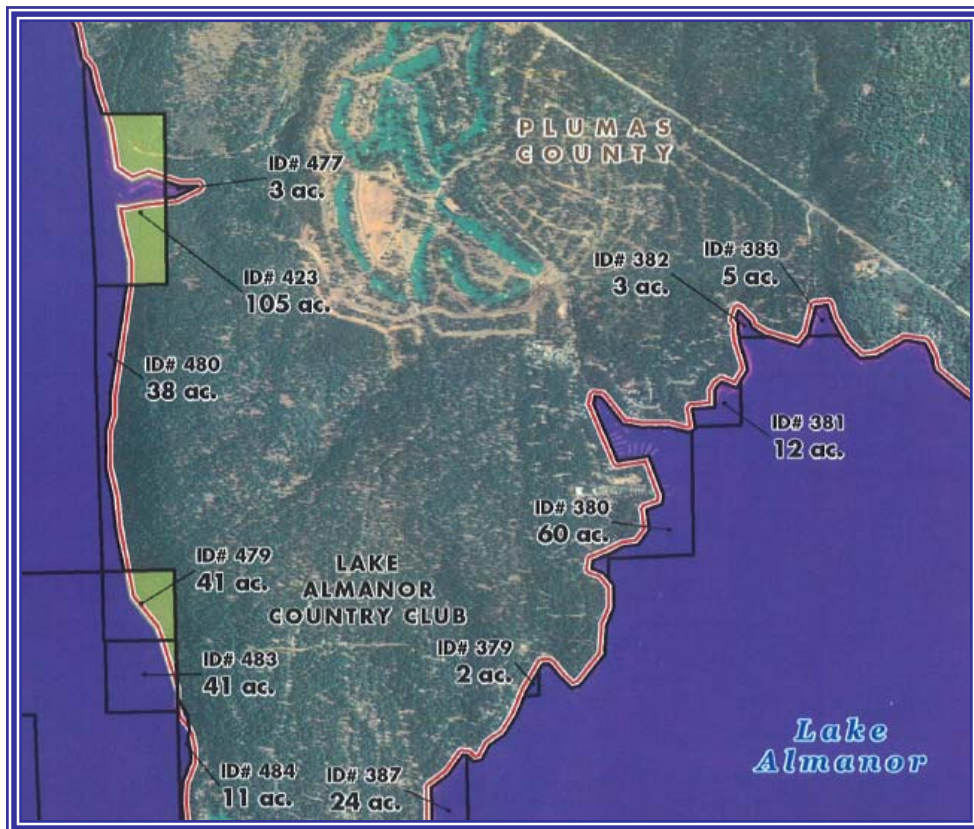

Submitted By:

County of Plumas

November 12, 2010



PART 1 - ORGANIZATIONAL INFORMATION

Contact Information

Primary Proposal Contact

Brian Morris
General Manager, Plumas County Flood Control & Water Conservation District
520 Main Street, Room 413
Quincy, CA 95971
(530) 283-6243
brianmorris@countyofplumas.com

Secondary Proposal Contact

Leah Wills
Consultant, Plumas County Flood Control and Water Conservation District
P.O. Box 44
Taylorsville, CA 95983
(530) 284-7294
Leah2u@frontiernet.net

Executive Officer – Plumas County

Jack Ingstad
County Administrative Officer
520 Main Street, Room 309
Quincy, CA 95971
(530) 283-6315
jackingstad@countyofplumas.com

Executive Summary

The County of Plumas is submitting this land conservation proposal to request fee title donation of a portion of parcel number 423 in the Lake Almanor Planning Unit, an area spanning the mouth of Bailey Creek on the west side of the Lake Almanor peninsula. Approximately 57 acres of the parcel are outside of the FERC boundary and were preliminarily designated for donation.

The Lake Almanor peninsula is generally designated as “prime opportunity area” in the Plumas County General Plan, which connotes the highest level of municipal infrastructure and opportunity for development. However, environmentally sensitive and important areas have been recognized on the peninsula, including an area that is designated as the Bailey Creek Open

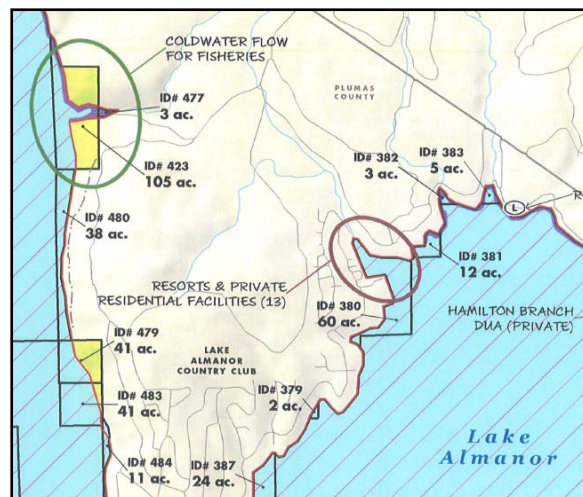

Space Corridor. Under a 1994 agreement between Plumas County, the California Department of Fish and Game, and private landowners, development is prohibited in the open space corridor and certain specified uses are allowed, including:

- Equestrian, hiking, and bicycle trails
- Timber harvesting in accordance with state law and subject to approval by the Department of Fish and Game
- Hunting, fishing, and general outdoor recreation
- Protection of historic and cultural resources
- Low-intensity day use picnic areas

In a September 2010 decision, the Plumas County Zoning Administrator approved a tentative subdivision map and planned development permit for the Lakefront at Walker Ranch project, which surrounds PG&E parcel 423. One of the conditions of approval requires the privately-owned area in the Bailey Creek Open Space Corridor to be dedicated to the County of Plumas or one of the dependent special districts governed by the Plumas County Board of Supervisors.

The PG&E parcel at the mouth of Bailey Creek abuts the Bailey Creek Open Space Corridor. Plumas County is seeking the donation of this parcel in fee title to provide for common ownership of the Bailey Creek area and coordinated resource management and enhancement.

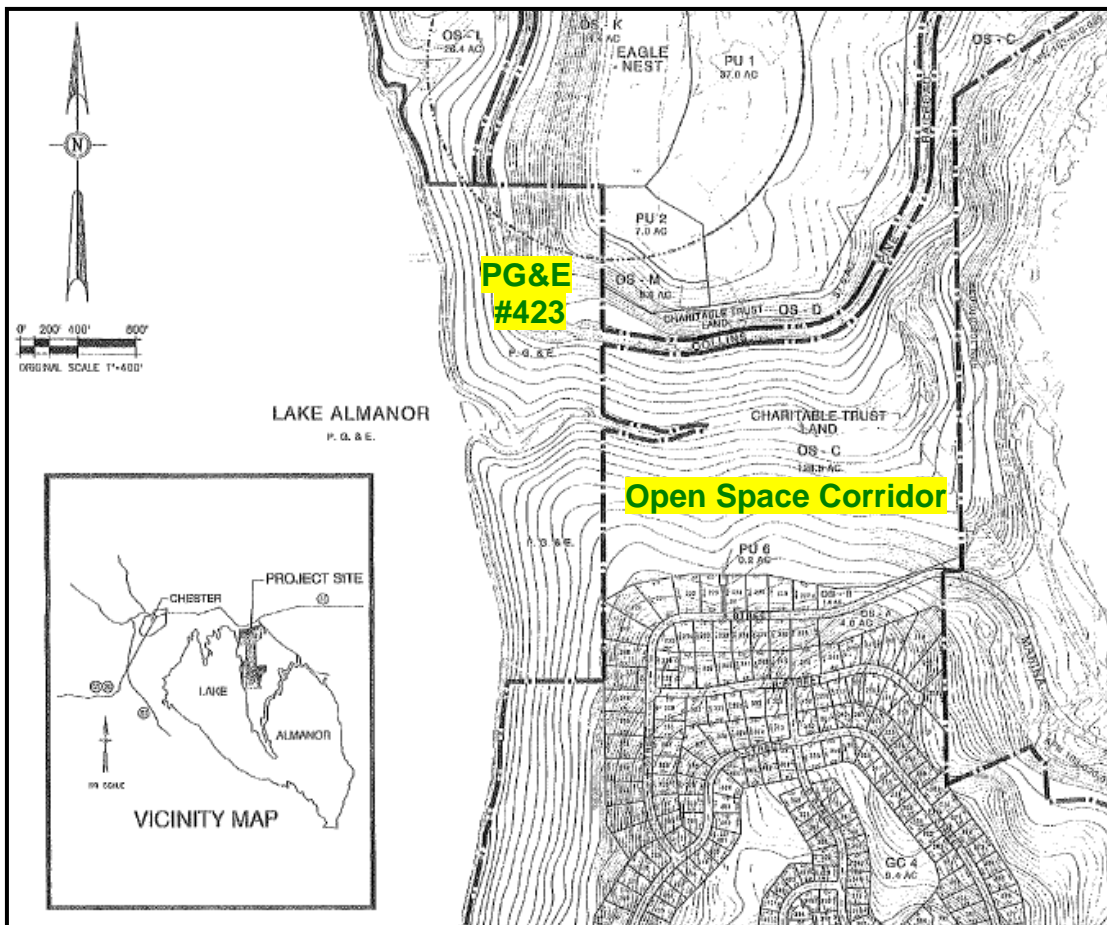

The conditions of approval for the Lakefront project also provide that one of the county's agencies will be responsible for the management and care of the open space area, including regular fuel treatment to reduce wildfire risk. A dedicated funding source will be established through development agreements to provide perpetual funding for these activities.

Organizational Information

Plumas County is a local governmental entity.

Legal Name: County of Plumas (a political and legal subdivision of the State of California)

Common Name: County of Plumas or Plumas County

Attached is a letter from Plumas County Administrative Officer Jack Ingstad approving the submittal of the land stewardship proposal and Plumas County's participation in the Stewardship Council's land conservation process.

Rationale for Applying

Plumas County is seeking the donation of PG&E's Bailey Creek lands to achieve common ownership of the Bailey Creek Open Space Corridor to ensure coordinated resource management and enhancement. As the local governmental agency with general jurisdiction over all matters, Plumas County's interest is to ensure the land is managed and conserved for the benefit of its residents and visitors and for future generations.

Organization's Mission

9. Please provide your organization's formal stated mission and explain how it is consistent with and supports the preservation and enhancement of the BPVs on the watershed lands.

Plumas County will be the leader in County Government, through respect for our citizens and care for our resources and through constant diligence and improvement of service to both.

The fact that Plumas County highlights "care for our resources" in its mission statement reflects the high stewardship ethic that is imbedded in our political leaders, public servants, and the community at large. Below are specific examples of how Plumas County's programs and priorities reflect our ongoing support of BPVs on watershed lands.

Protection of the natural habitat of fish, wildlife, and plants. The County of Plumas has more than 25 years of experience in carrying out habitat restoration, management, and monitoring projects as a member and primary sponsor of the Feather River Coordinated Resources Management Group. The County's Fish and Game Commission supports public education and acquisition of important habitat. The County's General Plan and GIS database recognize and protect important habitat areas and working landscapes. The County routinely engages local experts to conduct wildlife and botany surveys in support of various restoration projects. The County is currently implementing a \$7 million Integrated Regional Water Management grant that will include 50 miles of stream restoration and the restoration of nearly 5,000 acres of meadow, riparian, and wetland habitat.

Preservation of open space. The Open Space Element of the Plumas County General Plan integrates natural resources preservation, natural resources production, and outdoor recreation into the County's land use planning. As examples, the County has supported the Feather River Land Trust in the restoration of large areas in Sierra Valley and Genesee Valley and has experience with the issues involved in the long-term management of open space.

Outdoor recreation by the general public. The Plumas County General Plan establishes a goal of encouraging outdoor recreation opportunities in areas where necessary facilities and services can be provided. Plumas County maintains parks and public venues throughout the county, both independently and in cooperation with four recreation and parks districts. Plumas County is currently involved in the implementation of two Prop. 50 River Parkways grants to enhance recreational opportunities in Quincy and Portola.

Sustainable forestry. As a long-time supporter of the Herger-Feinstein Quincy Library Group Forest Recovery Act, Plumas County has particular expertise in sustainable forestry practices that balance the needs of forest health, habitat preservation, and fuels management. With the experience gained from surviving for two decades amidst the lawsuits and protests of the National Forest “timber wars,” the County has a unique perspective on the values and management practices that need to be considered in stewarding public forest lands.

Agricultural uses. Through land-use designations under its General Plan and as a member the Feather River Coordinated Resource Management Group, the Feather River Regional Water Management Group, and the Rock Creek/Cresta Ecological Resources Committee, Plumas County has supported the continuation of “working landscapes” by protecting agricultural lands and promoting sustainable agricultural practices. The County has worked with and provided funding to the Feather River Land Trust and the Upper Feather River Watershed Group to implement best management practices for grazing in areas throughout the Feather River watershed, including riparian fencing, off-stream water sources, and stocking levels.

Historical values. Plumas County routinely engages local experts to conduct cultural resources surveys in support of various projects. The County has worked with local Maidu organizations and other groups to conduct outreach and education to help ensure that planning and policy reflect the varied interests of our diverse population. The County also operates under a Memorandum of Understanding with the Greenville Rancheria for government-to-government consultation on any matters related to Native American interests. The Plumas County Museum is part of the county government structure, and the museum works with the Plumas County Historical Society on a variety of educational programs and tours.

Geographic Focus

10. Describe your organization’s relevant experience and interest in the region in which the watershed lands that are the subject of this proposal are located, as it relates to owning and managing lands, preserving and enhancing the BPVs, and working with land conservation partners.

Plumas County is the local government entity with general jurisdiction in the region. In the Lake Almanor area in particular, Plumas County has been the most active member of PG&E's Project 2105 relicensing collaborative and has advocated strongly for the recreation enhancements and environmental mitigation and enhancement measures that are included in the Project 2105 settlement agreement. Plumas County also established the Almanor Basin Watershed Advisory Committee, which oversees ongoing projects and programs to protect and enhance the Lake Almanor watershed. With diverse participation including Plumas and Lassen Counties, PG&E, the Maidu Summit, the Regional Water Quality Control Board, the United States Forest Service, the Point Reyes Bird Observatory, and others, the Watershed Advisory Committee is an invaluable forum for coordinating resources management and balancing many different interests.

Organizational Experience and Capacity

11. Describe up to three specific projects that most effectively illustrate your organization's relevant experience and capacity to own and manage lands, and to preserve and enhance resource values that are most comparable to the BPVs associated with the watershed lands that are the subject of this proposal.

FERC Project 2105 Relicensing - Plumas County played a central role in the relicensing of FERC Project 2105 (Lake Almanor/Upper North Fork Feather River) and has made financial and programmatic commitments to participate with PG&E in the ongoing management of the project and implementation of a new project license. The settlement agreement for the relicensing provides for a wide range of resource enhancements and management actions, including improvement of recreation facilities; a comprehensive water quality monitoring program; public safety measures in coordination with Plumas County law enforcement; and lake level management.

Gansner Park - Prop. 50 River Parkways Project - Gansner Park is the community park in the town of Quincy and it is owned and managed by the County of Plumas. The County was awarded a Prop. 50/River Parkways grant by the California Resources Agency to enhance the park by expanding fully accessible pathways and fishing spots, increasing recreational access, stabilizing the river banks, and adding interpretive elements. In addition to the enhancements the project itself will provide, this project is one of many examples of Plumas County's success in obtaining grant funds to support its priority programs.

Plumas Watershed Forum - Plumas County manages the Plumas Watershed Forum, a partnership with the California Department of Water Resources and State Water Project contractors. This multi-million dollar program has implemented more than 30 projects over the past four years, including watershed restoration, public education and outreach, water quality monitoring, water and forestry research, and long-term management planning. This program is another example of the County's success in obtaining funding to implement its natural resources programs as well as its ability to organize a program with the involvement of a diverse group of stakeholders.

Examples of participants whose projects and programs have been supported by the Plumas Watershed Forum include:

- Plumas National Forest
- Feather River College
- Feather River Coordinated Resource Management Group
- Maidu Cultural and Development Group

- Plumas Unified School District
- Plumas Corporation
- University of California Cooperative Extension
- Feather River Resource Conservation District
- Sierra Valley Resource Conservation District
- Ecosystem Sciences Foundation

12. Please describe the location, size, length of time held, uses, and current management practices for each property held or managed by your organization.

Plumas County owns many properties for a wide range of purposes. Examples of properties that are comparable to the lands proposed for fee-title donation include:

- Gansner Park in Quincy, a 100-acre area which is managed for public day use and recreation and is bisected by Spanish Creek. A project is currently underway to stabilize the stream banks and improve accessibility under a Prop. 50 River Parkways grant.
- Taylorsville Park, Campground, and Rodeo Grounds, a 160-acre parcel that is managed for day use and overnight use and the majority of which is forested uplands. Plumas County has completed accessibility and other upgrades to the facilities using Prop. 40 recreation funds and completed a fire-safe project on the forested portion of the property.
- Greenhorn Ranch included 50 acres of undeveloped, forested parcels under the jurisdiction of one of the special districts governed by the Board of Supervisors. Within the past two years, fuel treatment has been accomplished on all of the lands through a project carried out with the Plumas County Fire Safe Council.

Organizational Finances

13. As an attachment, please provide your organization’s operating budget for the current year and copies of financial statements for your organization’s three most recent fiscal years (e.g., statements through 12/31/2009, or 6/30/2009).

The operating budget for the current year and excerpts from the outside audits for the three most recently completed years have been submitted in separate PDF files.

14. For non-governmental organizations only, please summarize your organization’s sources of funding, and how this funding is invested and managed.

Not applicable.

15. Please identify any pending sources of grant funds or potential grant funds from which your organization has successfully received funding in the past. Please also describe your organization’s strategy for securing these additional sources of support.

Plumas County receives millions of dollars in grant funds from many sources and for a wide range of purposes. Examples of funding that relate to watershed and resource management include the following:

Integrated Regional Water Management: Plumas County has been awarded \$7 million in IRWM implementation funding under the Prop. 50 phase of the program and has taken the lead in organizing the Feather River Regional Water Management Group to obtain eligibility for additional funding through the Prop. 84 phase of the program.

Plumas Watershed Forum: From 2003 to 2006, Plumas County has obtained \$4 million dollars to date from the California Department of Water Resources and the State Water Project contractors. Plumas County will receive another \$4 million upon successful completion of the environmental impact report for the Monterey Amendments to the State Water Project contracts.

Sierra Nevada Conservancy: Plumas County was awarded a \$48,000 grant in 2007 for regional water and watershed planning.

Title II and Title III: Over the past ten years, Plumas County has received more than \$3 million under Title III of the Secure Rural Schools and Community Self Determination Act, much of which has been used for forest and watershed management planning. Plumas County has allocated another \$3 million under Title II of the act to the Plumas Resource Advisory Committee, which has allocated the funding for a wide range of projects enhancing resource management and improving recreation opportunities.

16. For public entities only, please identify the department that would acquire fee title to lands and whether use of timber revenue, lease revenue, or funding provided by the Stewardship Council for the specific land management objectives could and/or would be restricted to use on the donated lands.

Fee title would be obtained in the name of the County of Plumas and not in the name of any particular county department.

There is no lease revenue associated with the subject property. For the type of forest management that is sponsored by Plumas County, timber revenue typically offsets a portion of the cost of projects improving forest health and reducing fuel loading. No net revenue is anticipated from forest management activities.

In accordance with Government Code section 25355, any funding provided to Plumas County by the Stewardship Council for a particular purpose may only be used for the specified purpose.

Key Personnel/Staff

17. Please describe the current paid staff positions and/or key personnel in your organization that would be responsible for the day-to-day management activities as well as any proposed special projects (e.g., enhancements) for the watershed lands. In addition, please indicate if your organization has any volunteers and their function.

Day-to-day management would be coordinated with management of the rest of the Bailey Creek Open Space Corridor, which is the responsibility of the Walker Ranch Community Services District (WRCSD), a special district governed by the Plumas County Board of Supervisors.

WRCSD has a general manager and shares staff resources with the 380 employees working for the County of Plumas.

Forest and fuels management would be coordinated with the Plumas County Fire Safe Council and the California Department of Fish and Game.

Cold water flow for fisheries would be evaluated in conjunction with the Feather River Coordinated Resource Management Group, including the California Department of Fish and Game, U.S. Forest Service, Regional Water Quality Control Board, and Feather River Resource Conservation District, among others. Collectively, this group represents hundreds of years of experience in watershed management and stream restoration and the program manager, Jim Wilcox, was awarded the 2010 National Wetlands Award in recognition of his dedication and expertise.

Resource surveys would be conducted by botanists, biologists, and archeologists working as independent contractors for Plumas County. Plumas County is home to a substantial pool of professionals who routinely perform this type of work in the course of CEQA and NEPA review for the many forest and watershed restoration projects that are in the course of planning or implementation at any given time.

Generally, Plumas County does not use volunteers for resource management and enhancement activities.

Community Engagement and Collaboration

18. Describe collaborative efforts your organization has been engaged in with organizations and stakeholders either in the geographic region where the subject watershed lands are located or elsewhere.

Upper Feather River Integrated Regional Water Management Program

In 2005, the County of Plumas took the lead in adopting one of the first Integrated Regional Water Management (IRWM) plans in the State of California in coordination with the U.S. Forest Service and other local agencies and nongovernmental organizations. In 2007, the Upper Feather IRWM program was one of the first in the state to be awarded a \$7 million implementation grant to undertake a suite of projects to improve water quality and water supply and to restore habitat. In 2009, Plumas County organized the Feather River Regional Water Management Group to continue the IRWM program into the Prop. 84 phase of the State program. Plumas County has assembled more than 30 public agencies and non-governmental organizations to work collaboratively in the pursuit of additional implementation funding for watershed restoration and enhancement projects. The regional plan and additional information are available at:

<http://www.featherriverwater.com/regionalplanningirwm/featherriverwaterplan.html>.

Plumas Watershed Forum

The Plumas Watershed Forum is a partnership between the County of Plumas, the California Department of Water Resources, and the State Water Project contractors to implement watershed

restoration and management actions in the Upper Feather River region for local and statewide benefit. Since 2004, the Forum has overseen implementation of more than 30 projects, including stream and meadow restoration, aspen restoration, forest management, public outreach and education, water quality monitoring, planning, and water and forestry research. Annual reports and other information are available on the Forum's website at: <http://www.featherriverwater.com/plumaswatershedforum/annualreports.html>.

Quincy Library Group

Plumas County officials have played a central role in working through the Quincy Library Group to develop an innovative, consensus-based plan for forest management that balances the needs of forest health, habitat protection, fuels management, and economic activity. Implementation of the plan has been underway for over a decade, following the 1998 enactment of the Herger-Feinstein Quincy Library Group Forest Recovery Act. Forest Service research undertaken in conjunction with the prescribed forest management actions has demonstrated the program's effectiveness in controlling wildfires, enhancing and protecting habitat, and increasing water supply.

19. Describe your organization's most relevant experience soliciting stakeholder input on projects comparable to the transfer and permanent protection of land pursuant to Stewardship Council's land conservation program and process. Describe the approach that your organization would use to solicit stakeholder input and disseminate information to the public on proposed future activities or measures for, and management of, the subject watershed lands.

Plumas County's most similar experience soliciting stakeholder input for resource restoration and management activities is through the collaborative and consensus-based planning process of the Feather River Coordinated Resource Management Group, which has been functioning effectively for 25 years. This process engages the public, agency representatives, and project proponents through meetings, site visits, regular newspaper coverage, e-mail lists, and web postings of project details, all in an effort to achieve broad and complete stakeholder consensus – a prerequisite for moving forward with any project.

In the Lake Almanor basin, Plumas County has also established the Almanor Basin Watershed Advisory Committee, which holds monthly public meetings to review projects and discuss watershed issues. Recent areas of focus have included extension of the Lake Almanor Recreation Trail; public education and preventative measures related to invasive species; and an aggressive, privately funded water quality monitoring program for Lake Almanor.

For future projects and activities, public outreach by Plumas County will continue through newspaper coverage, use of existing watershed-focused e-mail distribution lists, public discussion at meetings of the Almanor Basin Watershed Advisory Committee, and use the Plumas County website and e-mail alert system.

Legal Compliance and Best Practices

20. Describe what best practices, standards, or guiding principles your organization uses to ensure all organizational operations are legally and ethically sound and in the public interest. Please attach a copy of your organization's written conflict of interest policy, if one exists.

The Plumas County government functions under a number of California laws that help ensure public accountability and transparency in all of its actions, including:

- The Ralph M. Brown Act, requiring that meetings of the Board of Supervisors and subsidiary bodies be noticed and open to the public.
- The Political Reform Act, prohibiting elected officials and staff from participating in matters where there is a financial conflict of interest, among other things.
- A.B. 1234, requiring periodic ethics training for elected officials.
- The California Public Records Act, making records of County business open and available to the public.
- The California Government Code, requiring public notice and public hearings for adoption of the County's annual budget and requiring an annual audit of County finances by an outside auditor.
- The California Penal Code, establishing a civil grand jury to monitor and review the actions of County government.
- The California Public Contracts Code, requiring competitive procurement for public works projects, as well as a Plumas County Purchasing Policy requiring competitive procurement for all goods and services not covered by the Public Contracts Code.

The County of Plumas has counsel on staff to review all actions to be taken by the Board of Supervisors and to provide ongoing advice to staff on legal and ethical issues.

The members of the Board of Supervisors and other elected county officers are ultimately accountable to the electorate, which helps ensure County actions are indeed in the public interest.

21. For non-governmental organizations only, please indicate whether your organization is currently nationally accredited with the Land Trust Accreditation Commission, and has adopted and operates in accordance with Land Trust Alliance standards and practices.

Not applicable.

22. Has your organization made provisions for another organization to assume ownership and management responsibilities for your assets in the event that your organization is unable to continue operations?

Plumas County is the default organization of local government and there is no other entity that would assume its assets. In the event of financial insolvency, county finances would be reorganized through a Chapter 9 municipal bankruptcy.

23. Describe any current violations of law associated with your organization.

None.

24. Please indicate if any applicable law or policy precludes your organization from accepting a conservation easement on the watershed lands for which you are seeking fee title. If so, indicate what form of satisfactory assurance you propose to offer instead.

Plumas County can accept a conservation easement on the watershed lands and does not propose any other form of assurance.

Conflict of Interest Disclosure

25. To assist the Stewardship Council in evaluating whether any actual or potential conflicts of interest may arise, please include a disclosure of any personal or financial relationships of which you are aware between (a) your organization and its members, trustees, directors, officers or stockholders, and (b) a member of the Stewardship Council's board, his or her family members, or the board member's constituent organization. The existence of such a relationship may or may not require the affected board member to refrain from participating in the consideration of any land transaction in which your organization is involved.

Robert Meacher is a member of the Plumas County Board of Supervisors and also a member of the Stewardship Council's board of directors. Supervisor Meacher has recused himself from any discussion or action taken by Plumas County in the preparation and submittal of this proposal.

PART 2 - LAND STEWARDSHIP INFORMATION

Land Interests Sought

26. Please identify the specific parcel(s) or portions of parcels that your organization is interested in receiving in fee title. Please refer to the background information packet for parcel identification numbers and approximate acreage.

Plumas County is seeking the fee title donation of that portion of parcel number 423 that is outside the FERC boundary. The portion of the parcel outside the FERC boundary is approximately 57 acres.

27. Please indicate if the transfer of the watershed lands identified above would require a lot line adjustment, boundary survey, or legal parcel split. Please describe any proposed lot line adjustment, boundary survey, or parcel split and indicate why the proposed measure is necessary and how the proposed lot line adjustment or parcel split would contribute to the preservation and enhancement of the BPVs. Please include these costs in your organization's budget and funding plan and indicate if your organization would contribute funds for these costs.

The proposed transfer can be accomplished through a lot line adjustment. PG&E staff has indicated that the transfer would not require a boundary survey because the new boundary would be defined as the FERC boundary and/or lake elevation contour line.

28. Please provide an overview of your organization's internal process for approving the acquisition of, and completing the transaction associated with, real property.

Plumas County will have to make a determination that the acquisition of the property is consistent with the Plumas County General Plan; receive formal approval of the acceptance by the Board of Supervisors; and execute a certificate of acceptance. Additional due diligence may be required depending upon the final terms of transfer and indemnification by PG&E.

Baseline and Enhanced Land Management

29. Please describe baseline and enhanced management activities or practices identified in your organization's proposed project budget and funding plan. Specifically, describe:

a) The proposed activities and how proposed activities would achieve baseline and enhanced management of the watershed lands (e.g., the frequency and nature of on-the-ground site management activities, the anticipated duration or frequency of proposed site activities, and the staffing associated with such activities);

The primary reason for seeking fee title to the subject parcel is to achieve common ownership with the adjoining Bailey Creek Open Space Corridor in order to provide for coordinated management and stewardship of the Bailey Creek area.

Plumas County would ensure the entire corridor is managed to maximize open space, habitat, and recreation values, while conducting periodic assessment of forest health conditions and fuel management activities. Plumas County would also evaluate opportunities to maximize the cold water contributions from Bailey Creek into Lake Almanor and to extend trails from the inland Bailey Creek area to Lake Almanor itself.

To provide a baseline for ongoing management, there will be an initial assessment of biological and cultural resources on the PG&E parcel. A management plan for the Bailey Creek corridor will be established in conjunction with mitigation measures and monitoring for the Lakefront at Walker Ranch project and the PG&E license for Project 2105.

b) How the proposed enhanced management activities would contribute to the management objectives for the planning unit listed in Volume II of the Land Conservation Plan and the Recommended Priority Measures;

In Volume II of the Land Conservation Plan, the only measure that is specific to Bailey Creek relates to coldwater flow for fisheries. Cold water habitat in Lake Almanor and its tributaries is a critical issue in the summer months, and there are times when the only suitable coldwater habitat is found in the areas of the lake where cold water is entering from springs or streams. Plumas County will seek to manage the Bailey Creek area to maintain shading and evaluate opportunities to maximize groundwater retention in the winter and spring and to contribute cooler water to summer baseflow.

The enhancement measures will also address the general objectives for forest and fuels management planning, identification and protection of cultural resources, and identification and control of any noxious weeds.

c) How the proposed enhanced management activities differ from current management by PG&E (to the extent such information is available);

The background information provided by the Stewardship Council notes that the parcel is thick with dead and downed trees. In conjunction with the responsibilities of the Walker Ranch

Community Services District in maintaining the Bailey Creek Open Space Corridor, there would likely be a higher frequency of assessment and fuel treatment to reduce the possibility of high-intensity, stand-replacing wildfire. This activity would help ensure the protection of important habitat resources, including bald eagle and osprey nesting and deer migration, as well as help protect water quality and aquatic habitat in Bailey Creek and Lake Almanor.

Plumas County has the additional interest of encouraging low-impact recreation activities. Trails are one of the permissible uses in the Bailey Creek Open Space Corridor, and acquisition of the subject PG&E parcel would provide connectivity to Lake Almanor itself.

Plumas County has previously worked with the Susanville Indian Rancheria to identify and address cultural resource issues in the Bailey Creek corridor. Transferring the PG&E parcel into Plumas County's ownership would facilitate future coordination over access and protection issues.

d) How the proposed baseline and enhanced land management activities would potentially impact public use of the watershed lands and any existing economic uses;

In conjunction with trail development through the eastern Bailey Creek corridor, extension of a trail system to the lakeshore would provide an opportunity for public access that currently does not exist.

The Stewardship Council's background information indicates the property has not been logged, so timber production does not appear to be an existing economic use. There are no recreation or commercial leases associated with the property or any other identified existing economic uses.

e) The timeline for when your organization would incur costs associated with the proposed enhanced management activities;

If the Stewardship Council will provide funding for any enhanced management activities, Plumas County will commit to near-term timetables to carry out those activities.

- Resource Surveys – Within the first year
- Bailey Creek Corridor Management Plan – Within two years
- Fuel treatment – Within three years

Absent Stewardship Council funding for these activities, Plumas County will pursue other resources which may have more variable timetables.

Other possible enhancements, such as cold water augmentation or trail development, will require further assessment to determine whether they are appropriate to the site. If the Stewardship Council establishes a grant-type process for future enhancement, funding may be requested in the future. If funding is not available through the Stewardship Council, Plumas County will pursue enhancements as funding is identified. In any event, funding for baseline management and fuel treatment will be provided through the Walker Ranch Community Services District.

f) How the proposed enhanced management activities would reflect applicable land management best practices.

As a public agency with a high commitment to resource stewardship, Plumas County works closely with state and federal resource agencies and other experts to ensure its activities reflect best management practices. In the particular area of sustainable forestry practices, much has been learned in the decade we have been implementing the Herger-Feinstein Quincy Library Group Forest Recovery Act.

Physical Enhancements/Capital Improvements

30. Please describe and explain any proposed physical enhancements or capital improvements identified by your organization and include these costs in your organization's proposed project budget and funding plan (e.g., trail, restrooms, habitat restoration project, fencing, youth facilities, etc.). Specifically, please describe how the proposed physical enhancements or capital improvements would contribute to the objectives listed in Volume II of the Land Conservation Plan and the Recommended Priority Measures for the planning unit. Please also include a timeline for when your organization anticipates incurring one-time costs and ongoing annual costs associated with proposed physical enhancements or capital improvements, taking into account satisfaction of all applicable regulatory requirements, including CEQA and NEPA. (four pages or less)

Given the limited activities allowed in the prescription for management of the Bailey Creek Open Space corridor, minimal physical enhancements or capital improvements are anticipated. At this time, the only possible improvement that has been identified in the construction of a trail from the eastern Bailey Creek corridor to Lake Almanor.

Land Conservation Partners and Youth Opportunities

31. Has your organization identified any potential land conservation partners to be involved in any of the proposed management or enhancement activities, including youth-related activities? If so, please name and describe their proposed role(s) and responsibilities.

Plumas County will work through established forums in which it has already partnered with other agencies and organizations to identify and reconcile stakeholder interests, including the Feather River Coordinated Resources Management Group and the Almanor Basin Watershed Advisory Committee.

32. Does your organization have previous experience working with the proposed land conservation partner organization(s)? Please describe.

Plumas County has been a member of the Feather River Coordinated Resources Management Group since its inception in 1985 and has extensive experience working with the other agencies and organizations that are involved. The Almanor Basin Watershed Advisory Committee was created by Plumas County in 2006 and the county has been continually engaged with its members.

33. Please provide a letter from the executive director or equivalent officer of each organization identified as a potential land conservation partner indicating the organization's committed interest in pursuing the activities and responsibilities identified.

Given the small size and limited resource issues of the subject parcel, Plumas County has not requested any formal land conservation partners at this time.

Public Input

34. Please describe how your organization has considered public input provided to the Stewardship Council to date in the development of this proposal.

The suggestion to consider building a conference center at Bailey Creek is inconsistent with the existing management prescription to minimize development and other impacts in the Bailey Creek Open Space Corridor.

Plumas County meets all of the public's desired general characteristics for a future landowner, including a demonstrated history of working collaboratively on issues related to forestry, fuels, fish, and wildlife; approaching management of watershed lands with a holistic view; and being a locally-based entity.

PART 3- SUPPORTING DOCUMENTATION

1) Internal Revenue Service Determination Letters. Not applicable.

2) Letter from the executive director or equivalent officer of your organization approving the submission of the land stewardship proposal and the organization's participation in the Stewardship Council's land conservation process for the subject planning unit.

Letter is attached.

3) Operating Budget (current year). Submitted as separate PDF.

4) Financial statements for the past three years Submitted as separate PDF.

Addendum: Feather River Request for Proposal Questions

1.) If your organization will be placing certain management or enhancement projects out to bid, please describe the projects or actions that would require a bid process. Please explain how it will be assured that your organization would have the necessary funding to complete the bidding process.

Fuel management projects are typically placed out to bid. Also, contracts for resource surveys and other professional services may be secured through competitive procurement. Accommodating bidding processes and adjusting budgets or projects timetable to align with winning bids are routine business practices.

2.) For Question #16 of the Invitation to Submit a Land Stewardship Proposal document, which applies to public entities, please further clarify any assurances that funds allocated to the planning units of interest (whether they be internal funds, grant funds, or Stewardship Council funds) will be utilized for that particular site and would not be lost due to the priorities of legislature or the governor.

As noted in response to Question 16, the California Government Code establishes a legal requirement that funds given to a county for a particular purpose may only be used for that purpose.

COUNTY ADMINISTRATIVE OFFICE

County Courthouse, 520 Main St., Room 309
Quincy, California 95971 (530) 283-6315 Fax: (530) 283-6288
E-mail: jackingstad@countyofplumas.com

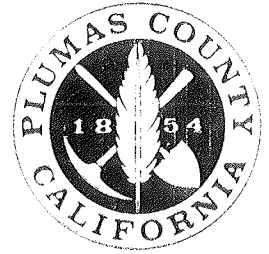

Jack Ingstad
County Administrative Officer

November 9, 2010

Allene Zanger
Executive Director
Pacific Forest and Watershed Lands Stewardship Council
15 North Ellsworth Avenue, Suite 100
San Mateo, CA 94401

Re: Approval to Submit Land Stewardship Proposal for the Lake Almanor Planning Unit

Dear Ms. Zanger:

The Plumas County Board of Supervisors has given approval for the County of Plumas to submit a Land Stewardship Proposal for the Lake Almanor Planning Unit.

Representatives of Plumas County are authorized to participate in the Stewardship Council's land conservation process for the Lake Almanor Planning Unit.

Sincerely,

A handwritten signature in cursive script, appearing to read "Jack Ingstad", is written over a horizontal line.

Jack Ingstad
County Administrative Officer

Pacific Forest and Watershed Lands Stewardship Council
Land Stewardship Proposal Budget and Funding Plan
Lake Almanor - Plumas County

PROJECT BUDGET - TRANSACTION COSTS

A. Document Preparation Costs

Task	Unit of Measure	Number of Units	Cost/Unit	Total Cost	Funding Request	Comments
Grant Deed / Legal Description	Deed	1	300	300	300	
Title Report	Report	1	1,470	1,470	1,470	
<i>To add a row: right click on the row above -> select copy -> right click again ->select insert copied cells</i>						
A. Total Document Preparation Costs				1,770	1,770	

B. Closing Costs

Task	Unit of Measure	Number of Units	Cost/Unit	Total Cost	Funding Request	Comments
Title Insurance	Transactio	1	1,240	1,240	1,240	
Escrow	Transactio	1	800	800	800	
Recordation	Transactio	1	180	180	180	
<i>To add a row: right click on the row above -> select copy -> right click again ->select insert copied cells</i>						
B. Total Closing Costs				2,220	2,220	

C. Other

Task	Unit of Measure	Number of Units	Cost/Unit	Total Cost	Funding Request	Comments
Lot Line Adjustment	Transactio	1	2,000	2,000	2,000	
<i>To add a row: right click on the row above -> select copy -> right click again ->select insert copied cells</i>						
C. Total Other				2,000	2,000	
TOTAL TRANSACTION COSTS				5,990	5,990	

Additional Notes:

Pacific Forest and Watershed Lands Stewardship Council
 Land Stewardship Proposal Budget and Funding Plan
 Lake Almanor - Plumas County

PROJECT BUDGET - BASELINE LAND OWNERSHIP AND MANAGEMENT ACTIVITIES (SEE NOTE 1)

PROJECT REVENUES

Source	Description	Non- SC Sources of Funding		Comments
		One-Time Grants	Ongoing Funding	
Committed Funds (cash received or award made)				
Grant Awards				
Fundraising				
Matching Funds				
Lease Revenues				
Timber Revenues				
General Fund/Reserves			1,200	
Walker Ranch Community Services District			1,600	
Total Committed Funds		-	2,800	
Pending Funds (no award made to date)				
Grant Awards				
Fundraising				
Matching Funds				
General Fund/Reserves				
Other (Describe)				
Total Pending or Potential Funds		-	-	
<i>To add a row: right click on the row above -> select copy -> right click again ->select insert copied cells</i>				
TOTAL PROJECT REVENUES		-	2,800	

PROJECT EXPENSES

A. Baseline Management Activities

Task	Description	Unit of Measure	Number of Units	Cost/Unit	One-Time Costs	Ongoing Annual Costs	SC Funding Request		Comments
							One-Time Costs	Ongoing Annual Costs	
Property Inspection	Periodoc review of property	Hours	48	54		2,592			
<i>To add a row: right click on the row above -> select copy -> right click again ->select insert copied cells</i>									
A. Total Baseline Management Activities					-	2,592	-	-	

Pacific Forest and Watershed Lands Stewardship Council
Land Stewardship Proposal Budget and Funding Plan
 Lake Almanor - Plumas County

B. Baseline Land Ownership Costs

Task	Description	Unit of Measure	Number of Units	Cost/Unit	One-Time Costs	Ongoing Annual Costs	SC Funding Request		Comments
							One-Time Costs	Ongoing Annual Costs	
<i>To add a row: right click on the row above -> select copy -> right click again ->select insert copied cells</i>									
B. Total Baseline Land Ownership Costs					-	-	-	-	

C. Other

Task	Description	Unit of Measure	Number of Units	Cost/Unit	One-Time Costs	Ongoing Annual Costs	SC Funding Request		Comments
							One-Time Costs	Ongoing Annual Costs	
<i>To add a row: right click on the row above -> select copy -> right click again ->select insert copied cells</i>									
C. Total Other					-	-	-	-	

TOTAL PROJECT EXPENSES					-	2,592	-	-	
-------------------------------	--	--	--	--	---	--------------	---	---	--

NET REVENUE/(EXPENSE) - BASELINE LAND OWNERSHIP AND MANAGEMENT ACTIVITIES					-	(2,592)	-	-	
--	--	--	--	--	---	----------------	---	---	--

Additional Notes:

Note 1: According to the Stewardship Council's Land Conservation Program Funding Policy, the Stewardship Council will require future land owners to demonstrate that they have the funding and other capacity to maintain that property interest so as to preserve and/or enhance the beneficial values on the Watershed Lands. Exceptions to this guideline will be rare and considered only in circumstances where,
 1) The funding of baseline land ownership and management activities will clearly lead to enhancement of the beneficial public values on the lands; and/or,
 2) The funding of baseline land ownership and management activities is only temporary (≤5 years).

Pacific Forest and Watershed Lands Stewardship Council
Land Stewardship Proposal Budget and Funding Plan
 Lake Almanor - Plumas County

PROJECT BUDGET - ENHANCEMENTS TO BENEFICIAL PUBLIC VALUES

PROJECT REVENUES

Source	Description	Non- SC Sources of Funding		Comments
		One-Time Grants	Ongoing Funding	
Committed Funds (cash received or award made)				
Grant Awards				
Fundraising				
Matching Funds				
Lease Revenues				
Timber/Biomass Revenues		36,000	4,500	
General Fund/Reserves				
Walker Ranch Community Services District - Fuel Treatment- Open Space Maintenance			3,000	
Total Committed Funds		36,000	7,500	
Pending Funds (no award made to date)				
Grant Awards - Plumas County Fire Safe Council (ave annual contribution)			1,500	
Fundraising				
Matching Funds				
General Fund/Reserves				
Other (Describe)				
Total Pending or Potential Funds		-	1,500	
<i>To add a row: right click on the row above -> select copy -> right click again ->select insert copied cells</i>				
TOTAL PROJECT REVENUES		36,000	9,000	

PROJECT EXPENSES

A. Enhanced Land Management Activities

Task	Description	Unit of Measure	Number of Units	Cost/Unit	One-Time Costs	Ongoing Annual Costs	SC Funding Request		Comments
							One-Time Costs	Ongoing Annual Costs	
Fuel Reduction	Ave annual fuel treatment	Acre	3	3,000		9,000			
Resource Surveys	Biological/cultural res. Invent	Hours	120	65	7,800		7,800		
Fuel Reduction	Initial fuel reduction	Acre	30	1,800	54,000		54,000		
Management Plan	Bailey Creek Open Space Pla	Hours	160	75	12,000		12,000		
<i>To add a row: right click on the row above -> select copy -> right click again ->select insert copied cells</i>									
A. Total Enhanced Land Management Activities					73,800	9,000	73,800	-	

Pacific Forest and Watershed Lands Stewardship Council
Land Stewardship Proposal Budget and Funding Plan
 Lake Almanor - Plumas County

B. Capital Improvements

Task	Description	Unit of Measure	Number of Units	Cost/Unit	One-Time Costs	Ongoing Annual Costs	SC Funding Request		Comments
							One-Time Costs	Ongoing Annual Costs	
<i>To add a row: right click on the row above -> select copy -> right click again ->select insert copied cells</i>									
B. Total Capital Improvements					-	-	-	-	

C. Other

Task	Description	Unit of Measure	Number of Units	Cost/Unit	One-Time Costs	Ongoing Annual Costs	SC Funding Request		Comments
							One-Time Costs	Ongoing Annual Costs	
<i>To add a row: right click on the row above -> select copy -> right click again ->select insert copied cells</i>									
C. Total Other					-	-	-	-	

TOTAL PROJECT EXPENSES					73,800	9,000	73,800	-	
NET REVENUE/(EXPENSE) - ENHANCEMENT OF BENEFICIAL PUBLIC VALUES					(73,800)	(9,000)	109,800	-	

Additional Notes: